

Motor Controller Voltage Conversion

The JobMaster® Mechanical Bench Motor Controller (catalog number 26-0000-0003) is set by default to 115V, but it can be converted to receive a voltage of 230V.



Warning

Ensure that the motor controller is NOT connected to a power source before starting this procedure.

To convert voltage from 115V to 230V:

1. From the right side of the front panel, remove the yellow sticker blocking the fuse box and socket.



Note that the fuse selector shows **115V**.



2. Using a small flathead screwdriver, remove the fuse box as shown.

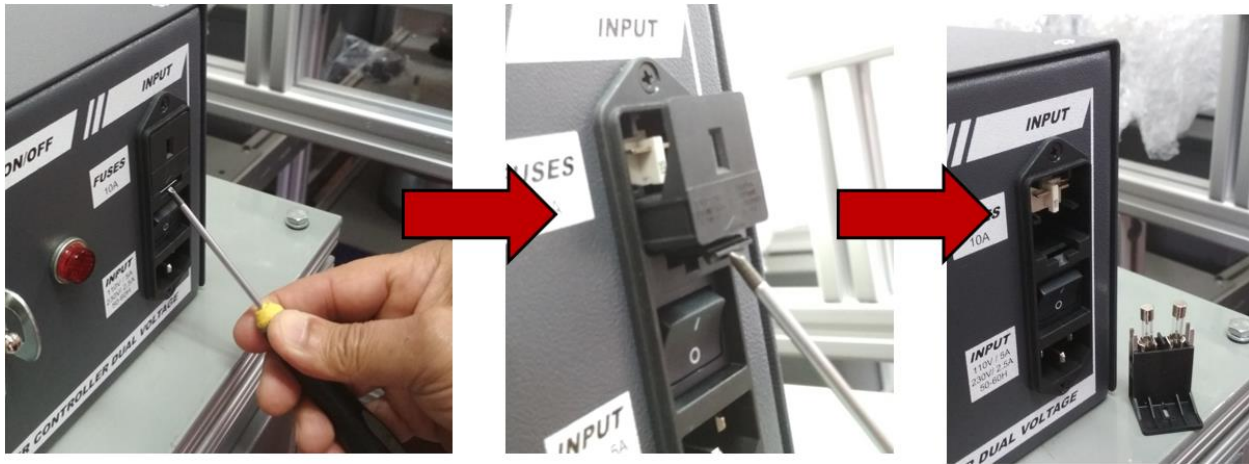

3. Using the screwdriver, remove the white voltage selector as shown.



4. Rotate the voltage selector so that **230V** is facing outwards. Return the selector to its slot by pushing it inward. You should hear a click when the selector has reached the correct location.

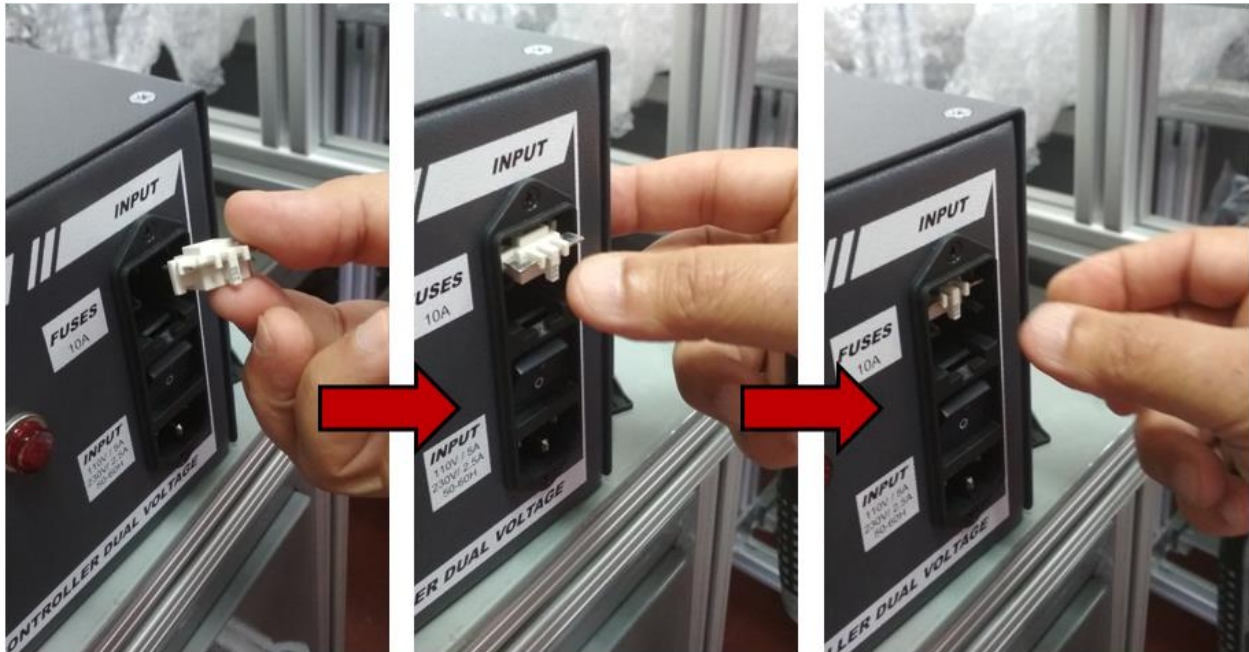

5. Return the fuse box to its slot. You should hear a click when it is properly in place. Note that the fuse box now shows **230V**.

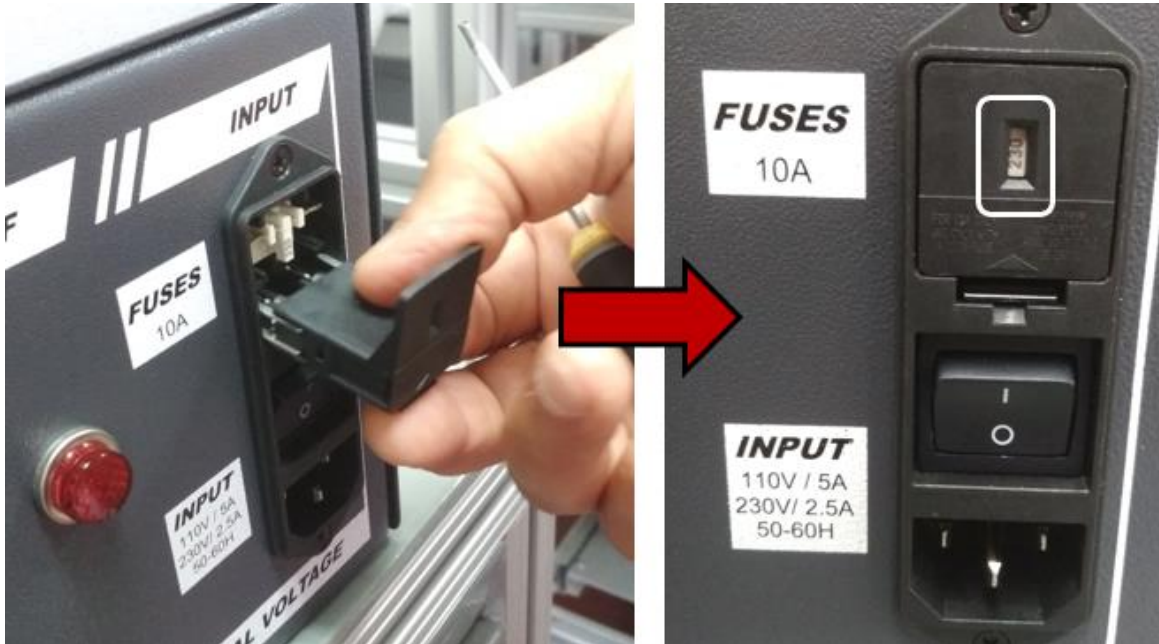

The controller is now ready to use with 230V.

- ⓘ **Note:** If, by mistake, you have powered the controller with the incorrect voltage, replace the fuses with 10A Short (S.B) fuses from the accessory box (catalog number 410530) and switch the voltage selector as described above.